

THE EXPERT IN HOUSING SOLUTIONS



## CONTAINER HOUSE

ZHEJIANG PUTIAN INTEGRATED HOUSING CO.,LTD.

SALES OFFICE:  
3-1601 NO.1 DIKAI PLAZA,NO.471 JINCHENG ROAD,XIAOSHAN HANGZHOU CHINA  
TEL:+86-571-83513788 FAX:+86-400 826 6163-05190

FACTORY:  
BEILIU ROAD,BINHAI DEVELOPMENT ZONE,SHAOXING,CHINA  
TEL:+86-575-85796699 FAX:+86-575-85796688  
Http://www.putianhouse.com  
Email:inquiry@putianhouse.com

ZHEJIANG PUTIAN INTEGRATED HOUSING CO.,LTD.





## COMPANY PROFILE

Established in 2003, PTH is a leader in the Steel Structure industry. Certified by CE, BV IFA & ISO9001. We can design and manufacture all types of Steel Structure houses or buildings to suit your personal or business needs. We offer project support on any, or all, phases of the steel design and detailing based on your project requirements. PTH works with you to fully research, design, engineer, manufacture and also (if needed) help erect your Steel Structure building. PTH products are exported to over 60 countries worldwide; our professional, highly qualified staff always respond quickly to requests and inquiries. Providing consultation and delivery of a full range of steel structure design projects which can range from individual or smaller developments to multi-million dollar projects. 4S Service Network – PTH has recently opened retail showrooms in Toronto, Canada & Bahrain and plan to expand into Australia, Europe, South Africa, Russia and the Middle East with many more countries to follow. Our 4S retail showrooms feature a full service network including: pre-sale consulting & design services, sales & shipment services, installation guidance services and most importantly after-sales customer support service.

## FACTORY OVERVIEW

- Our Factory & Main Products have been verified by Bureau Veritas (BV)
- Our Factory is located in Shaoxing, Zhejiang, China; 25 minutes from the Hangzhou International Airport & 90 minutes from Shanghai & Ningbo City.
- 150 employees including 30 engineers and 35 senior skilled workers
- Professional FrameCAD from New Zealand specializing in Light Steel Villas
- 45,000 M2 building area, includes 2 workshops 35,000 M2 total
- More than 100 sets advanced production lines
- Capacity For Steel Structure Houses: 100000 m2
- Capacity For Light Steel Villas: 80000 m2
- Capacity For Steel Container Houses: 3000 units

## CERTIFICATION





## ABOUT CONTAINER HOUSE

PTH container house is a kind of modular house, consisting of light steel frame and thermal insulation material. It is a new type of energy conservation and environment protection house which is easy and convenient to install. Currently, the PTH container houses have been exported to more than 70 countries all over the world (such as Brazil, South Africa, Dubai, Japan etc.) It is widely used in the construction sites, temporary residence, shower room, kitchen, teaching building, office, coldstorage house, switch board room, and military camouflage house etc. PTH container house is CE, BV&TUV certificated, Its wind resistance can reach 210km/h, and the seismic resistance can be more than Grade 8. Its service life can be more than 10 years.

Besides the standard 20' container house, PTH can also offer you 10', 16', 40' container house and other sizes according to your demand. What's more, container modules can be combined. It can be stacked upto 4 layer in the vertical, and it can be combined with any quantity or any position in the horizontal. PTH is trying its best to solve the housing problem for clients.

The fully welded light steel frame is firstly galvanized then painted with anti-corrosive paints which makes the house more firm and more durable. The roof of the container house is integrated with PU (steel structural frame+colored steel sheet on both sides+PU foaming), so the water proof is well solved. Bearing capacity is 0.5t. As for the electrical wiring, they are firstly installed in the roof which will make the installation more convenient and more safe. The wall system is consisted of sandwich panel (colored steel sheets on both sides and thermal insulation, or stainless steel sheet with thermal

insulation). As for the insulation, you can choose EPS, PU, ROCK WOOL(density: 120kg/m<sup>3</sup>). The thickness of the external wall is 75mm or 100mm, and generally the partition board is 50mm. The window and door are fitted on the wall panel, so you can easily adjust their position by exchanging the places of the wall panels; you can also add more windows and doors. The bottom of the container house is fitted with fork lift holes, providing the option to move it. The standard floor is laminated floor or PVC floor. In order to get more comfortable living place, you can also add more insulation such as rockwool.

PTH also supply you quality guaranteed shower room, kitchen equipments, air cooler etc. According to the client's demands, we can also supply other equipments.







1



2



3

## USAGE

- 1. Living room  
Provide also the bed and other furniture.
- 2. Office  
High quality furniture is available.
- 3. Kitchen  
High quality cabinet, cooking appliances etc.



- 4. Cold storage room  
Well sealed, 98% cold air kept in the house. A container house can save 8° electricity in every 24h.
- 5. Public shower room  
6 shower rooms in one 20FT container house.
- 6. Toilet  
6 toilets in one 20FT container house.



4



5

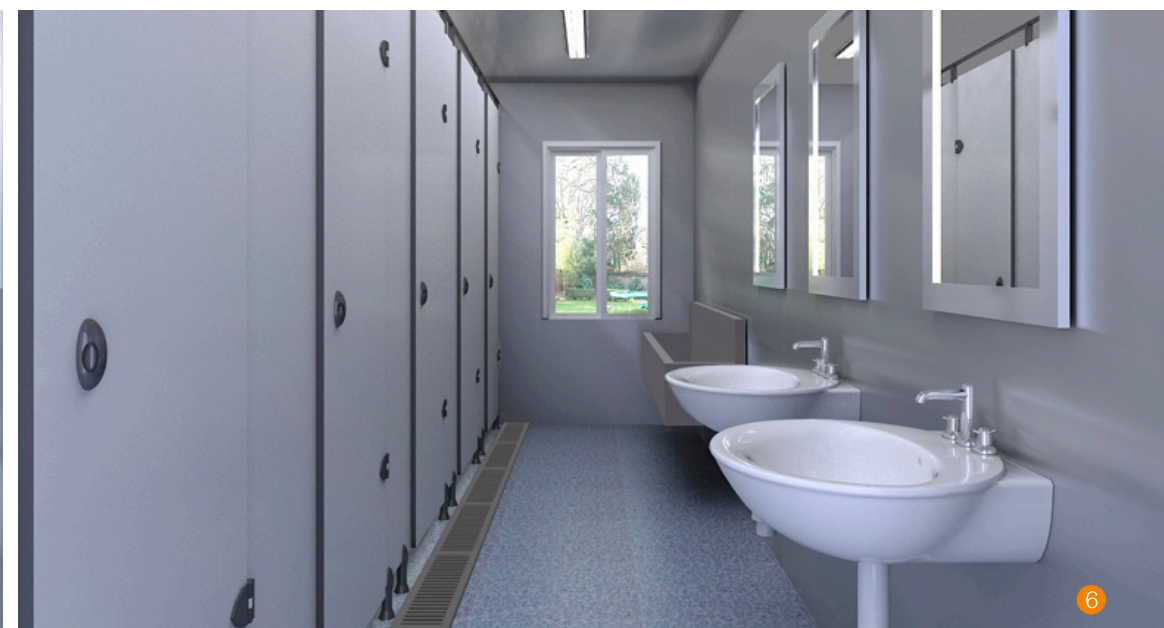

6



# I HOUSE TYPE

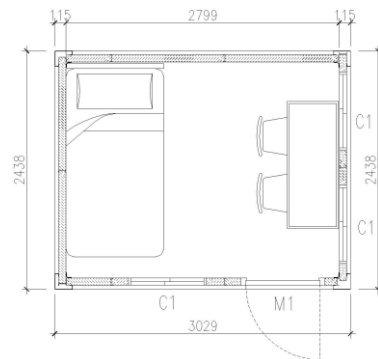

## PTJ-8\*10A

1. Size: 3029mm\*2438mm\*H2591mm
2. Exterior steel door: 860mm\*2050mm
3. PVC single glass sliding window: 800mm\*1100mm
4. Floor: plywood + laminated floor
5. Electricity: one light, one switch, one socket, one set of distribution box and breaker
6. All steel members galvanized
7. Usage: sentry box, living room

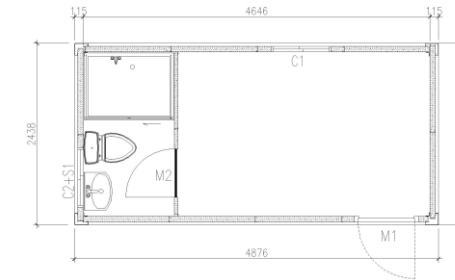

## PTJ-8\*16B

1. Size: 4876mm\*2438mm\*2591mm
2. Exterior steel door: 860mm\*2050mm  
Interior sandwich door: 700mm\*2000mm
3. PVC single glass sliding window size: 800mm\*1100mm; 800mm\*400mm (figured glass)
4. Ventilator: 250mm\*250mm
5. Floor: bedroom--plywood+laminated floor; bathroom--fiber cement board + PVC floor
6. Electricity: two lights, two switches, two sockets, one set of distribution box
7. One wash basin + one toilet + one shower room
8. All steel members galvanized
9. Usage: dorms in the construction site, single department

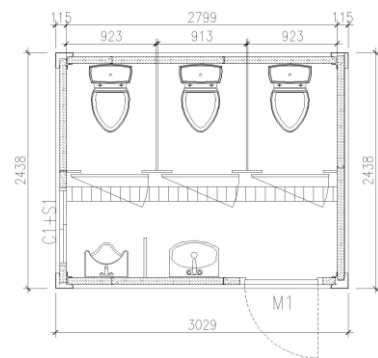

## PTJ-8\*10B

1. Size: 3029mm\*2438mm\*H2591mm
2. Exterior steel door: 860mm\*2050mm
3. Ventilator: 250mm\*250mm
4. Floor: fiber cement board + PVC floor
5. Electricity: one light, one switch, one socket, one set of distribution box and breaker
6. One Wash basin + three toilets + one urinal + partition board
7. All steel members galvanized
8. Usage: toilet

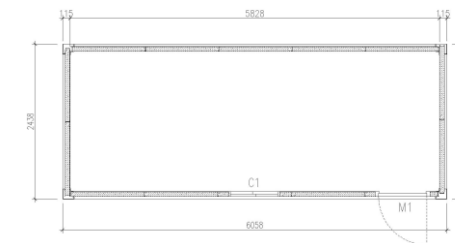

## PTJ-8\*20A

1. Size: 6058mm\*2438mm\*2591mm
2. Exterior steel door: 860mm\*2050mm
3. PVC single glass sliding window size: 800mm\*1100mm
4. Floor: plywood + laminated floor
5. Electricity: two lights, one switch, two sockets, one set of distribution box and breaker
6. All steel members galvanized
7. Usage: dorms in the construction site, classrooms

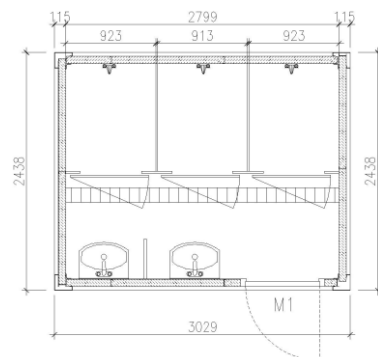

## PTJ-8\*10C

1. Size: 3029mm\*2438mm\*H2591mm
2. Exterior steel door: 860mm\*2050mm
3. Floor: fiber cement board + PVC floor
4. Electricity: one light, one switch, one socket, one set of distribution box and breaker
5. One Wash basin + three shower sprays + one urinal + partition board
6. All steel members galvanized
7. Usage: shower room in the construction site

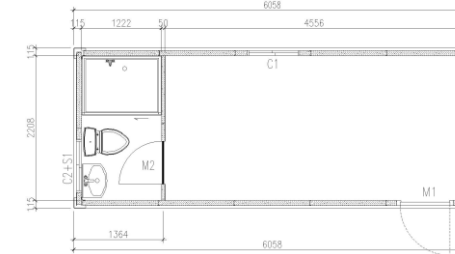

## PTJ-8\*20B

1. Size: 6058mm\*2438mm\*2591mm
2. Exterior steel door: 860mm\*2050mm  
Interior sandwich door size: 700mm\*2000mm
3. PVC single glass sliding window size: 800mm\*1100mm; 800mm\*400mm (figured glass)
4. Ventilator: 250mm\*250mm
5. Floor: bedroom--plywood + laminated floor; bathroom--cement fiber board + PVC floor
6. Electricity: three lights, two switches, two sockets, one set of distribution box
7. One wash basin + one toilet+one shower room
8. All steel members galvanized
9. Usage: dorms in the construction site, single department

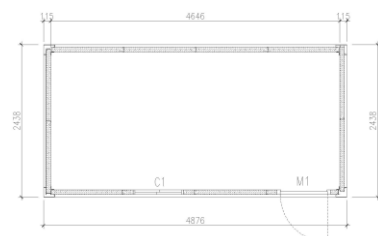

## PTJ-8\*16A

1. Size: 4876mm\*2438mm\*2591mm
2. Exterior steel door :860mm\*2050mm
3. PVC single glass sliding window size: 800mm\*1100mm
4. Floor: plywood + laminated floor
5. Electricity: two lights, one switch, two sockets, one set of distribution box and breaker
6. All steel members galvanized
7. Usage: dorms, classrooms

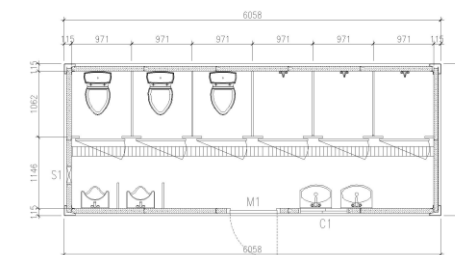

## PTJ-8\*20C

1. Size: 6058mm\*2438mm\*2591mm
2. Exterior steel door :860mm\*2050mm
3. PVC single glass sliding window size: 800mm\*1100mm
4. Floor: cement fiber board + PVC floor
5. Electricity: two lights, one switch, one set of distribution box and breaker
6. Two wash basin + 3 toilets + 3 shower rooms + 2 urinals
7. All steel members galvanized
8. Usage: dorms in the construction site, classrooms



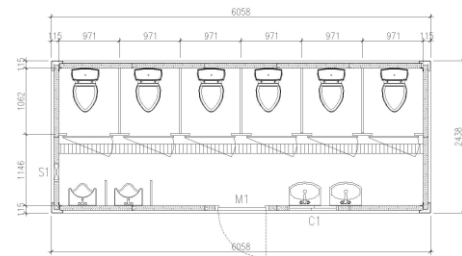

**PTJ-8\*20D**

1. Size: 6058mm\*2438mm\*2591mm
2. Exterior steel door: 860mm\*2050mm
3. PVC single glass sliding window size: 800mm\*1100mm
4. Ventilator: 250mm\*250mm
5. Floor: cement fiber board + PVC floor
6. Electricity: two lights, one switch, one set of distribution box and breaker
7. 2 wash basin + 6 toilets + 2 urinals
8. All steel members galvanized
9. Usage: toilets in the construction site

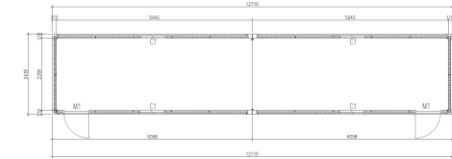

**PTJ-8\*20J**

1. Size: 6058mm\*2438mm\*2591mm\*2
2. Exterior steel door: 860mm\*2050mm
3. PVC single glass sliding window size: 800mm\*1100mm
4. Floor: plywood + laminated floor
5. Electricity: 4 lights, 2 switch, 4 sockets, one set of distribution box and breaker
6. All steel members galvanized
7. Usage: classroom, dorms, hotel, living house

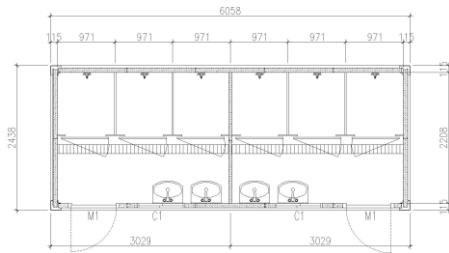
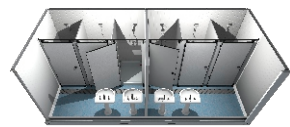

**PTJ-8\*20E**

1. Size: 6058mm\*2438mm\*2591mm
2. Exterior steel door: 860mm\*2050mm
3. PVC single glass sliding window size: 800mm\*1100mm
4. Floor: fiber cement board + PVC floor
5. Electricity: two lights, one switch, one set of distribution box and breaker
6. 2 wash basin + 6 shower rooms + 2 urinals
7. All steel members galvanized
8. Usage: shower rooms in the construction site

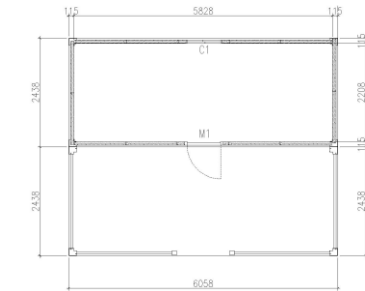
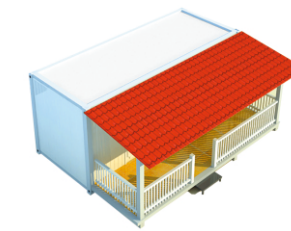

**PTJ-8\*20K**

1. Size: 6058mm\*2438mm\*2591mm\*2
2. Exterior steel door: 860mm\*2050mm
3. PVC single glass sliding window size: 800mm\*1100mm
4. Floor: plywood + laminated floor
5. Electricity: 4 lights, 2 switch, 4 sockets, 2 sets of distribution box and breaker
6. PVC handrail: 11mm
7. All steel members galvanized
8. Usage: living house

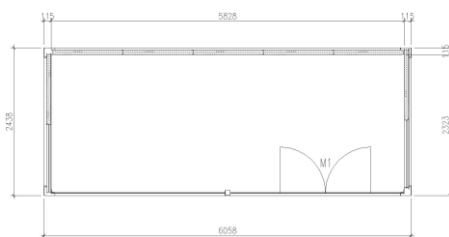
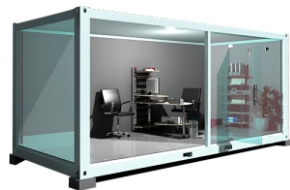

**PTJ-8\*20G**

1. Size: 6058mm\*2438mm\*2591mm
2. Exterior steel door: 860mm\*2050mm
3. Floor: plywood + laminated floor
4. Electricity: two lights, one switch, one set of distribution box and breaker
5. All steel members galvanized
6. Usage: exclusive shop, showcase, office

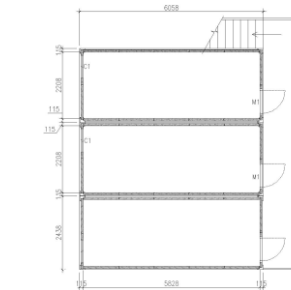
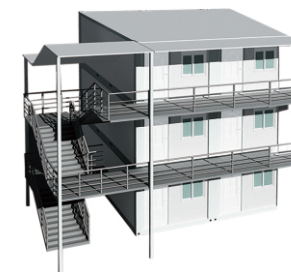

**PTJ-8\*20L**

1. Size: 6058mm\*2438mm\*2591mm\*4
2. Exterior steel door: 860mm\*2050mm
3. PVC single glass sliding window size: 800mm\*1100mm
4. Floor: plywood + laminated floor
5. Electricity: 8 lights, 4 switch, 8 sockets, four sets of distribution box and breaker
6. Other facilities: steel Stairway (frame galvanized); balcony (frame galvanized) Canopy (frame galvanized)
7. All steel members galvanized
8. Usage: house in the construction site, dorms, hotel

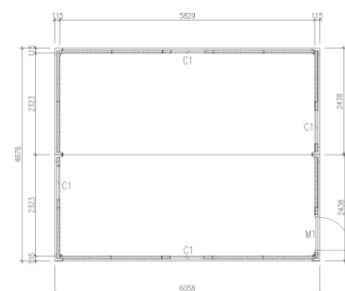

**PTJ-8\*20H**

1. Size: 6058mm\*2438mm\*2591mm
2. Exterior steel door: 860mm\*2050mm\*2
3. 4 windows: PVC single glass sliding window size: 800mm\*1100mm
4. Floor: plywood + laminated floor
5. Electricity: 4 lights, 2 switch, 4 sockets, one set of distribution box and breaker
6. All steel members galvanized
7. Usage: classroom, dorms, hotel

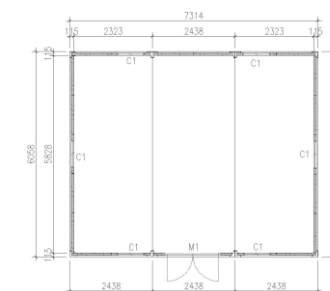

**PTJ-8\*20M**

1. Size: 6058mm\*2438mm\*2591mm\*3
2. Exterior steel door: 860mm\*2050mm
3. PVC single glass sliding window size: 800mm\*1100mm
4. Floor: plywood + laminated floor
5. Electricity: 6 lights, 3 switch, 6 sockets, four sets of distribution box and breaker
6. Roof: 70 serial galvanized keel, 0.5mm glaze tile
7. All steel members galvanized
8. Usage: house in the construction site, dorms, hotel

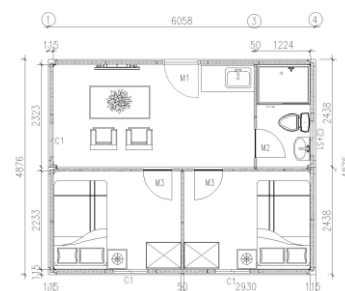

**PTJ-8\*20I**

1. Size: 6058mm\*2438mm\*2591mm
2. Exterior steel door: 860mm\*2050mm
3. Interior sandwich door size: 700mm\*2000mm
4. PVC single glass sliding window size: 800mm\*1100mm
5. 800mm\*400mm (figured glass)
6. Ventilator: 250mm\*250mm
7. Floor: bedroom--plywood + laminated floor; bathroom--fiber cement board + PVC floor
8. Electricity: 5 lights, 3 switches, 4 sockets, one set of distribution box
9. One wash basin + one toilet + one shower room
10. All steel members galvanized
11. Usage: classroom, dorm, hotel, living house

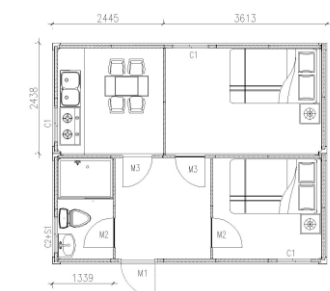

**PTJ-8\*20N**

1. Size: 6058mm\*2438mm\*2591mm
2. Exterior steel door: 860mm\*2050mm
3. Interior sandwich door size: 700mm\*2000mm
4. PVC single glass sliding window size: 800mm\*1100mm
5. 800mm\*400mm (figured glass)
6. Ventilator: 250mm\*250mm
7. Floor: bedroom--plywood + laminated floor; bathroom--cement fiber board + PVC floor
8. Electricity: 5 lights, 4 switches, 6 sockets, one set of distribution box One set of Outdoor junction box
9. One wash basin + one toilet + one shower room
10. All steel members galvanized
11. Usage: living house, dorm



**PTJ-8\*200**

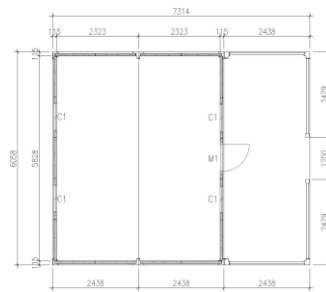

1. Size: 6058mm\*2438mm\*2591mm
2. Exterior steel door :860mm\*2050mm
3. PVC single glass sliding window size:800mm\*1100mm,
4. Floor: plywood + laminated floor;
5. Electricity: six lights, three switches, four sockets, one set of distribution box and breaker
6. 70mm roof steel keel and 0.5mm color steel glaze tile
7. PVC handrail
8. All steel members galvanized
9. Usage: office, dormitory, living room

**PTJ-10\*20C**

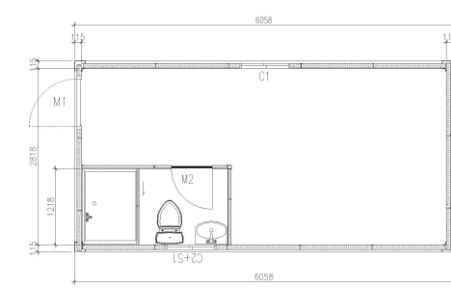

1. Size: 6058mm\*2438mm\*2591mm
2. Exterior steel door :860mm\*2050mm  
Interior sandwich door size: 700mm\*2000mm
3. PVC single glass sliding window size:800mm\*1100mm  
800mm\*400mm(figured glass)
4. Ventilator: 250mm\*250mm
5. Floor: bedroom--plywood + laminated floor; bathroom--  
cement fiber board + PVC floor
6. Electricity:3 lights, 2 switches, 3 sockets, one set of  
distribution box, one set of Outdoor junction box
7. One wash basin + one toilet + one shower room
8. All steel members galvanized
9. Usage: living house, dorm, office

**PTJ-10\*16A**

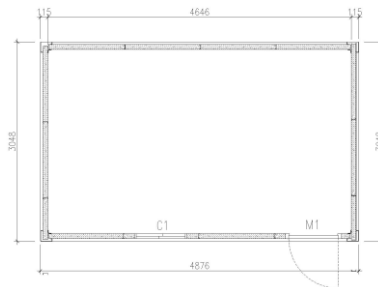

1. Size: 4876mm\*2438mm\*2591mm
2. Exterior steel door :860mm\*2050mm
3. PVC single glass sliding window size:800mm\*1100mm
4. Floor: plywood + laminated floor
5. Electricity: two lights, one switch, two sockets, one set of  
distribution box and breaker
6. All steel members galvanized
7. Usage: dorms in the construction site, classrooms

**PTJ-10\*20D**

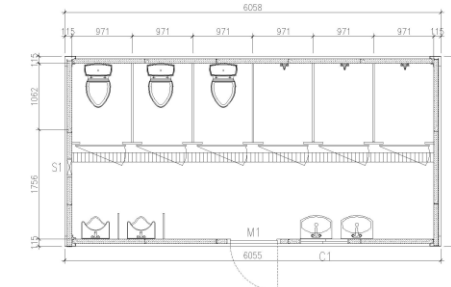

1. Size: 6058mm\*2438mm\*2591mm
2. Exterior steel door :860mm\*2050mm
3. PVC single glass sliding window size:800mm\*1100mm
4. Ventilator: 250mm\*250mm
5. Floor: fiber cement board + PVC floor
6. Electricity: two lights, one switch, one set of distribution box  
and breaker
7. 2 wash basins + 3 toilet + 3 shower rooms + 2 urinals
8. All steel members galvanized
9. Usage: toilet

**PTJ-10\*16B**

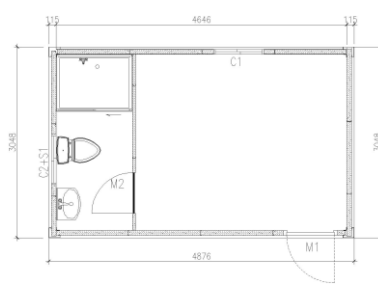

1. Size: 4876mm\*2438mm\*2591mm
2. Exterior steel door :860mm\*2050mm  
Interior sandwich door size: 700mm\*2000mm
3. PVC single glass sliding window size:800mm\*1100mm;  
800mm\*400mm(figured glass)
4. Ventilator: 250mm\*250mm
5. Floor: bedroom--plywood+laminated floor;  
bathroom--cement fiber board + PVC floor
6. Electricity: three lights, two switches, two sockets, one  
set of distribution box
7. One wash basin + one toilet + one shower room
8. All steel members galvanized
9. Usage: dorms in the construction site, single department

**PTJ-10\*20E**

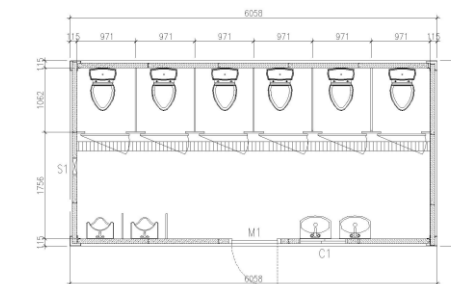

1. Size: 6058mm\*2438mm\*2591mm
2. Exterior steel door :860mm\*2050mm
3. PVC single glass sliding window size: 800mm\*1100mm
4. Ventilator: 250mm\*250mm
5. Floor: fiber cement board + PVC floor
6. Electricity: two lights, one switch, one set of distribution box  
and breaker
7. 2 wash basins + 6 toilet + 2 urinals
8. All steel members galvanized
9. Usage: toilet

**PTJ-10\*20A**

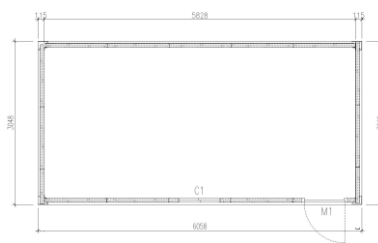

1. Size: 6058mm\*2438mm\*2591mm
2. Exterior steel door :860mm\*2050mm
3. PVC single glass sliding window size:800mm\*1100mm
4. Floor: plywood + laminated floor
5. Electricity:2 lights, 1 switch, 2 sockets, one set of  
distribution box and breaker
6. All steel members galvanized
7. Usage: living house, dorm, hotel

**PTJ-10\*20F**

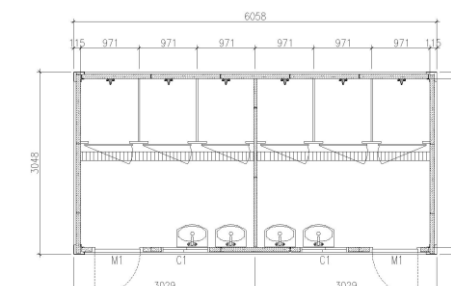

1. Size: 6058mm\*2438mm\*2591mm
2. Exterior steel door :860mm\*2050mm
3. Floor: fiber cement board + PVC floor
4. Electricity: two lights, two switch, one set of distribution box  
and breaker
5. 4 wash basins + 6 shower rooms
6. All steel members galvanized
7. Usage: shower rooms in the construction site

**PTJ-10\*20B**

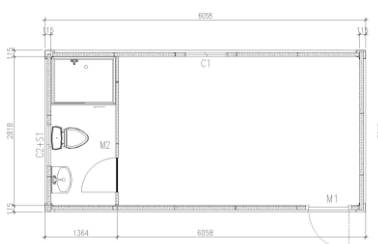

1. Size: 6058mm\*2438mm\*2591mm
2. Exterior steel door :860mm\*2050mm  
Interior sandwich door size: 700mm\*2000mm
3. PVC single glass sliding window size:800mm\*1100mm  
800mm\*400mm(figured glass)
4. Ventilator: 250mm\*250mm
5. Floor: bedroom--plywood + laminated floor;  
bathroom--fiber cement board + PVC floor
6. Electricity: 3 lights, 2 switches, 3 sockets, one set of  
distribution box,one set of Outdoor junction box
7. One wash basin + one toilet + one shower room
8. All steel members galvanized
9. Usage: living house, dorm, office

**PTJ-10\*20J**

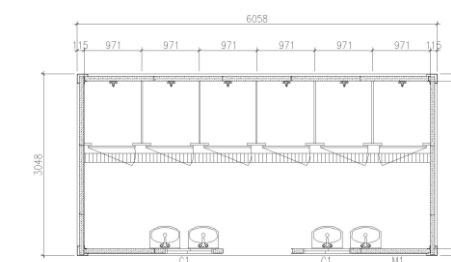

1. Size: 6058mm\*3048mm\*2591mm
2. One exterior steel door: 860mm\*2050mm
3. Floor: fiber cement board + PVC floor;
4. Electricity: two lights, two switches, one set of distribution box  
and breaker
5. Four washbasins and six shower rooms
6. All steel members galvanized
7. Usage: public shower room

**PTJ-10\*24A**

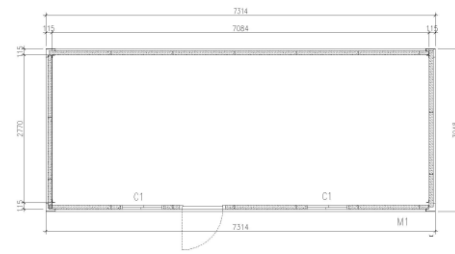

1. Size: 7315mm\*3048mm\*2591mm
2. Exterior steel door: 960mm\*2050mm
3. PVC single glass sliding window size: 800mm\*1100mm
4. Floor: plywood + laminated floor
5. Electricity: 2 lights, 2 switches, 2 sockets, one set of distribution box and breaker
6. All steel members galvanized
7. Usage: living room ,dorm, office

**PTJ-10\*24B**

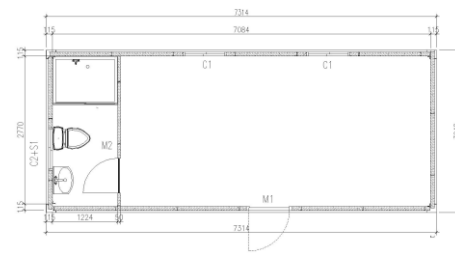

1. Size: 7315mm\*3048mm\*2591mm
2. Exterior steel door: 860mm\*2050mm
3. Interior sandwich door size: 650mm\*2000mm
4. PVC single glass sliding window size: 800mm\*1100mm  
800mm\*400mm(figured glass)
5. Floor: bedroom--plywood + laminated floor;  
bathroom--fiber cement board + PVC floor
6. Electricity: 3 lights, 3 switches, 2 sockets, one set of distribution box
7. One wash basin+ one toilet+one shower room
8. All steel members galvanized
9. Usage: living room, dorm, office

**PTJ-10\*24C**

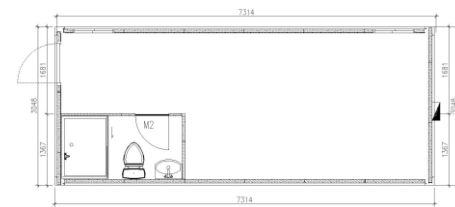

1. Size: 7315mm\*3048mm\*2591mm
2. Exterior steel door: 860mm\*2050mm
3. Interior sandwich door size: 650\*2000mm
4. PVC single glass sliding window size: 800mm\*1100mm;  
800mm\*400mm(figured glass)
5. Floor: bedroom--plywood + laminated floor;  
bathroom--fiber cement board + PVC floor
6. Electricity: 3 lights, 3 switches, 2 sockets, one set of distribution box
7. One wash basin + one toilet + one shower room
8. All steel members galvanized
9. Usage: living room, dorm, office

**PTJ-10\*24D**

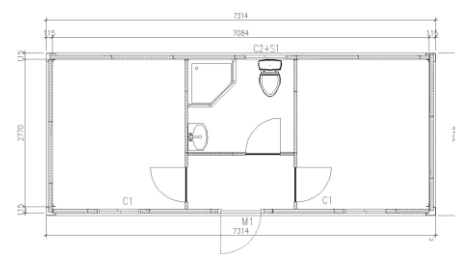

1. Size: 7315mm\*3048mm\*2591mm
2. Exterior steel door: 860mm\*2050mm
3. Two interior door: sandwich door size: 650\*2000mm
4. PVC single glass sliding window size: 800mm\*1100mm;  
800mm\*400mm(figured glass)
5. Floor: bedroom--plywood + laminated floor;  
bathroom--fiber cement board + PVC floor
6. Electricity: 4 lights, 3 switches, 2 sockets, one set of distribution box
7. One wash basin + one toilet + one shower room
8. All steel members galvanized
9. Usage: living room, dorm, office

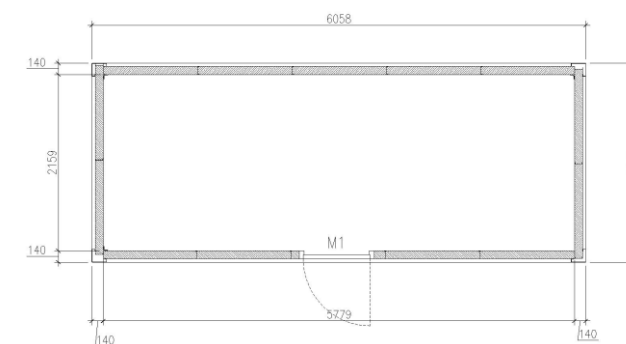

**PTJ-8\*20F**

- 1. Size: 6058mm\*2438mm\*2591mm
- 2. Exterior steel door: 860mm\*2050mm
- 3. Floor: fiber cement board + PVC floor
- 4. Electricity: two lights, one switch, one set of distribution box and breaker
- 5. One refrigerator + rack
- 6. All steel members galvanized
- 7. Usage: freezer house (temperature to -18 degree C) for meat storage; cold room (temperature to 0 degree C) for vegetable and fruits.



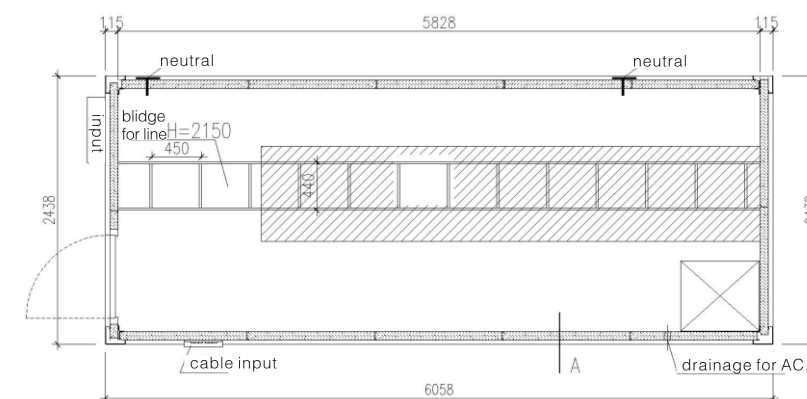
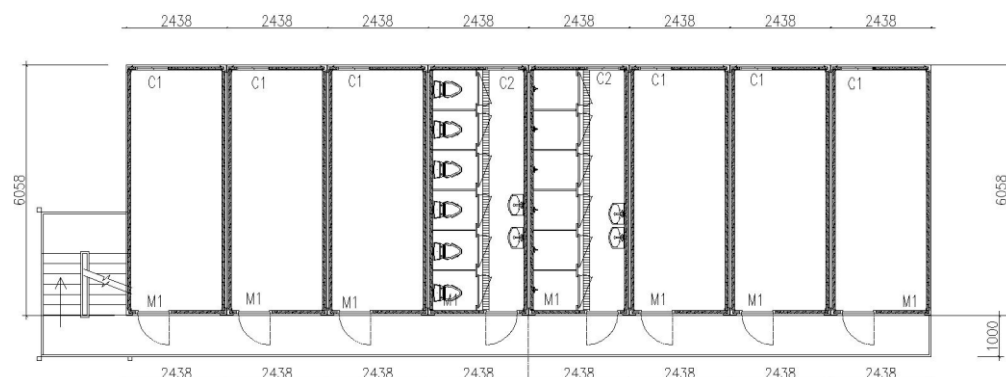
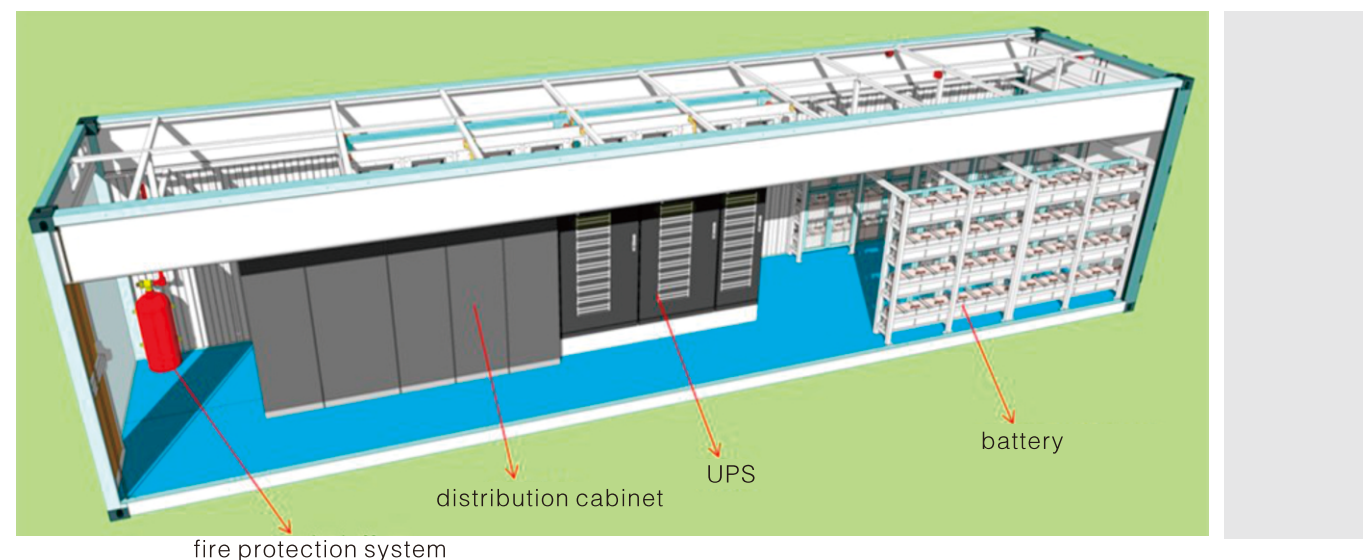
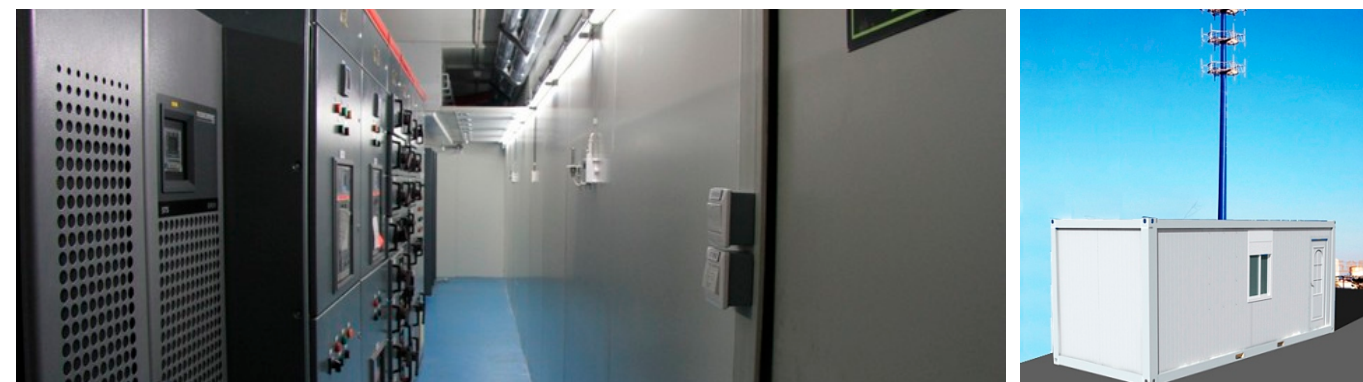

**PTJ-8\*20P**

- 1. Size: 6058mm\*3048mm\*2591mm\*24 unit each floor
- 2. Exterior steel door: 860mm\*2050mm
- 3. PVC single glass sliding window size:800mm\*1100mm, 800mm\*400mm(figured glass)
- 4. Floor: living room--plywood + laminated floor; bathroom--fiber cement board + PVC floor
- 5. Electricity: two lights, one switches, two sockets, one set of distribution box and breaker for each room
- 6. Other facilities such as steel stairs, balcony, canopy
- 7. All steel members galvanized
- 8. Usage: hotel, dormitory, living room

**PTJ-8\*20Q**

- 1. Size: 6058mm\*3048mm\*2591mm
- 2. one steel security door: 860mm\*2050mm
- 3. floor: fiber cement board + PVC floor
- 4. Electricity: two lights, one switch, two sockets, one set of distribution box and breaker
- 5. all steel memebers galvanized
- 6. bridge for wires
- 7. AC sepcial
- 8. Used as special communication station. Advantages: equipment installation rack/ input wire box preseted, use 100mm PU sandwich wall panel to achieve excellent heat protection which can eaquals to three time of 240mm brick wall, save 60% energy. And it has high installation effectiveness, high tightness, excellent performance of wind and seismic resistance.



**2. Beam**

Made of Q345B once-molded, all galvanized and well painted.

**1. Corner fitting**

Made of Q345B according to the ISO standard, the same as the shipping container. all galvanized and well painted.

**3. Frame soldering**

Sealed soldering makes the frame more firm.

**4. Frame polishment**

Polishment makes the frame surface more smooth and makes the paint evenly coated.

**5. Painting workshop**

The FC paints with good adhesive force, makes the container house bright and fresh.

**6. Installed the wires&conduits in advance**

The inner space will be more beautiful.

**7. Columns**

All stamped out by machine, accuracy guaranteed.

**8. Assembling**

Assembled precisely in the mold.

**9. Flooring**

Laminated wood floor, beautiful and comfortable.

# MANUFACTURING QUALITY ASSURANCE

Container house workshop  
10,000sqm, capacity reaches to 3,000 units per year.



**Checking&Packaging**

- 1. Checking  
Carefully check the shipping list, making sure no mistake.
- 2. Packing  
Option one: a standard container house packed in one flat pack, 4 sets combined into one package, it can be shipped on board just as one 20' shipping container. The package will be protected by plywood boards around and thin film wrapped.  
Option two: mixed packaging. Roof and chassis will be packed together with bolts; all the wall panels packed together with wooden pallet in the bottom, corrugated board on the surface, and XPS board in the interspace. It will be shipped in 40' container.



**Packing for container house**

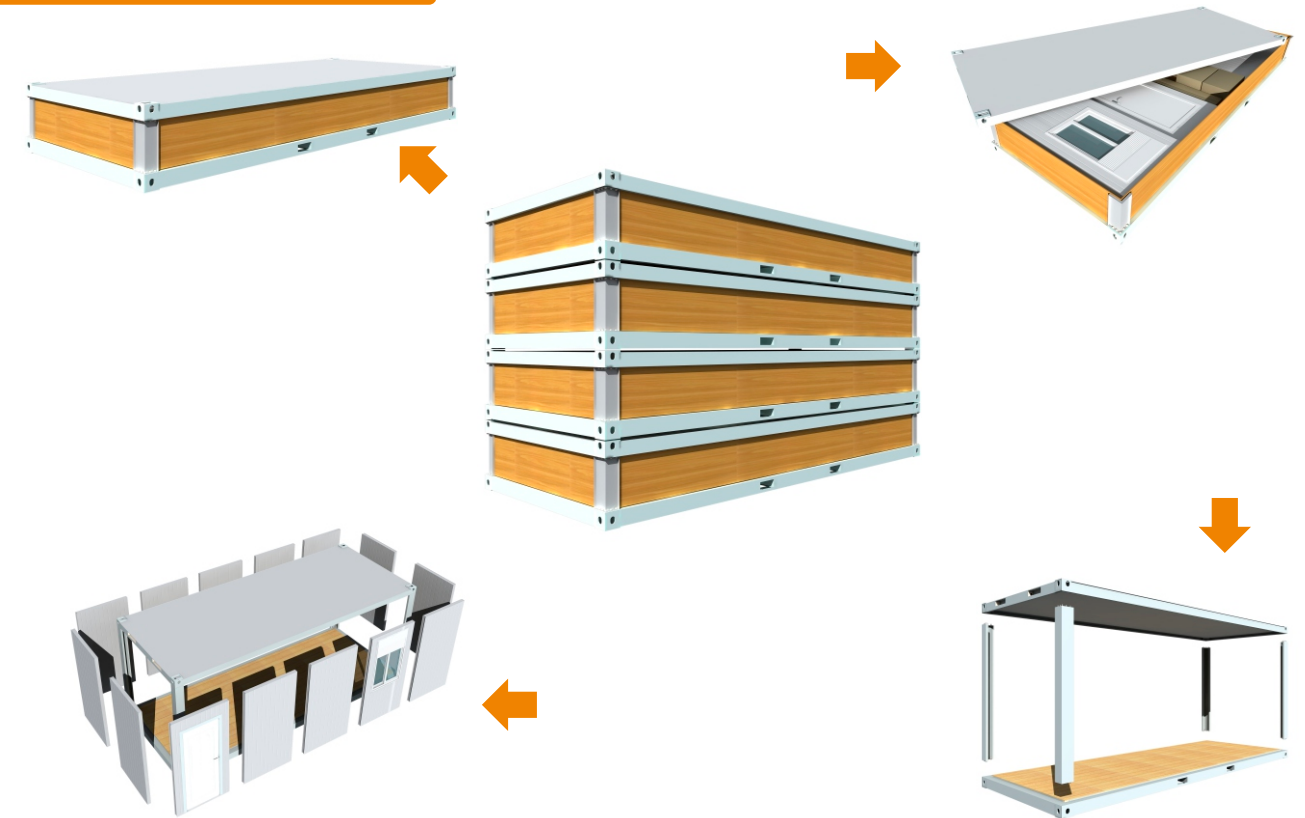

**Loading & Shipment**

- 1. 4 flat packs will be one package it can be shipped on board just as one 20' shipping container.
- 2. Mixed packaging: top and bottom packed together with bolts; all wall panels packed together on wooden pallet, wrapped by corrugated board on the surface, and XPS board between panels. The package it will be then shipped in 40' shipping container.



**Unloading**

- 1. Bulk shipment  
A: Take out the small packages;  
B: Use folk lift to take out the wall panel packages;  
C: Rig the corner of the container house and drag the package out;  
D: Use folk lift to lift the container package in the middle and move it out of the shipping container;  
E: Put the package on ground sidwise .
- 2. 20FT SOC  
A: Unbolt the container packages at the corners ;  
B: Sling one container package and lay on floor;  
C: Open the package by free the screws on four corners;  
D: Sling the roof;  
E: Take out the wall panels and other parts inside;  
F: Take off the steel bars at four corners and the plywood back plates.



## | SEMI-FINISHED PRODUCTS



Standard chassis

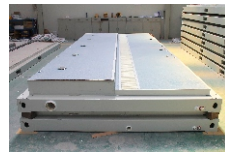

Chassis of toilet container house

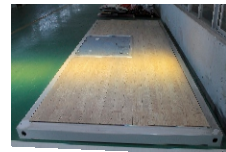

Chassis with toilet in the middle

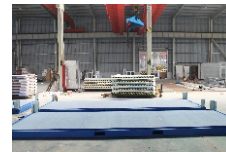

Chassis with PVC floor

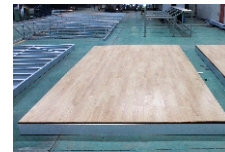

Light steel chassis

### Introduction of the chassis of the container house

Frame made of Q345 steel plate bended to profile, and welded, and galvanized. Coated with anti-corrosive paint. Laying materials: laminated board, PVC board, blockboard, cement fiber board etc.



### Wall system series

- Standard wood pattern wall panel.
- Standard blue wall panel.
- Inner door standard wall panel.
- External door(steel security door)fitted in standard yellow wall panel.
- External door(steel security door)fitted in standard block pattern wall panel.
- External door(steel security door)fitted in standard blue wall panel.
- Window(PVC aluminium alloy window) fitted in the standard wall panel size:800\*1,100mm.
- Window(PVC aluminium alloy window) fitted in the standard wooden pattern wall panel size:800\*1,100mm.
- Bathroom ventilated window(PVC aluminium alloy window) together with exhaust fan being fitted in the wall panel. Size: 800\*400mm

### Introduction of the wall system

Consists of 0.42mm colored steel sheets on both sides or one 0.42 colored sheet and one 0.42mm stainless steel sheet, integrated with PU\EPS\ROCK WOOL etc. The size of the wall is 2310mm\*1158mm. The thickness of the external wall is 75mm, and the internal wall is 50mm. The density of the EPS is 12kg\m<sup>3</sup>, the density of the rock wool is 120kg\m<sup>3</sup>. And the color of the wall is as per the clients' demands.

## | SUPPORTING FACILITIES



Squatting pot



Water closet



Wash basin



Urinal



Cabinet



Shower room



Air cooler

## | ACCESSORIES



Base board



Inner corner pedestal



Corner parts



Corner rib



Plastic seaming rib

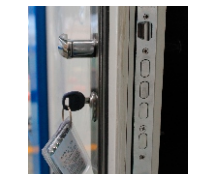

Security door lock



Steel security door



Electrical



Inner corner

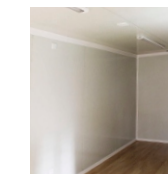

Inside view



Exhaust fan



Switch(AM, AU, BR, Taiwan standard)







Location: Venezuela  
Quantity: 500 units  
Type: PTJ-8\*20B PTJ-8\*20C  
PTJ-8\*20D PTJ-8\*20E  
Producing time: 2012. 11. 25

A 3D architectural rendering of the modular housing complex, showing the layout of the units and the central courtyard. The units are white with red trim, and the courtyard has a green mat and a playground.





Location: Gabon  
Quantity: 300 units  
Type: PTJ-8\*20D PTJ-8\*20E  
PTJ-8\*20J  
Producing time: 2011.11.25







Location: Qatar



Location: Cyprus



Location: New Caledonia



Location: Canada



Location: Brazil



Location: South Korea



Location: Austria



Location: Dubai



Location: USA



Location: Mozambique



Location: Iraq



Location: South Africa





Bahrain



FRANCE: Customer made exterior cladding.



Location: Finland  
Quantity: 30 units  
Type: PTJ-8\*20A PTJ-8\*20I PTJ-8\*20M  
Producing time: 2012.11.25  
Special used in the cold region.





Japan project: 60 units



Chile project: 260 units



Indonesia project: 92 units



Iraq project: 120 units



# INSTALLATION INSTRUCTION

1. Put the chassis levelled, put the columns on the corner, align the holes for screws, screw from the upsides.



2. Put the roof on the columns, align the holes for screws on four corners, screw from the downsides.



3. Firstly install the long side wall panels, lean the wall panels into the house.



4. Fix all the wall panels.

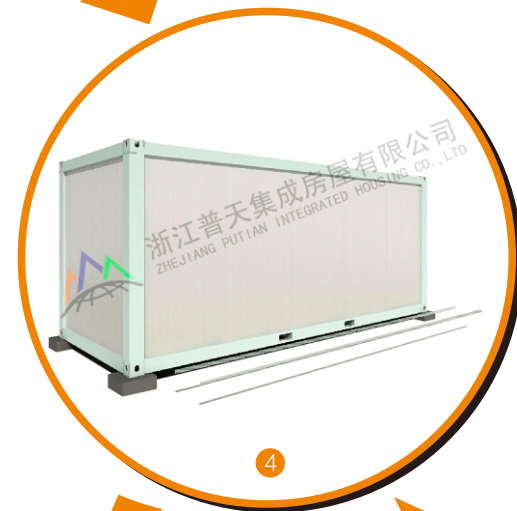

5. Install the internal decoration.



6. Install the decoration rib on the roof.

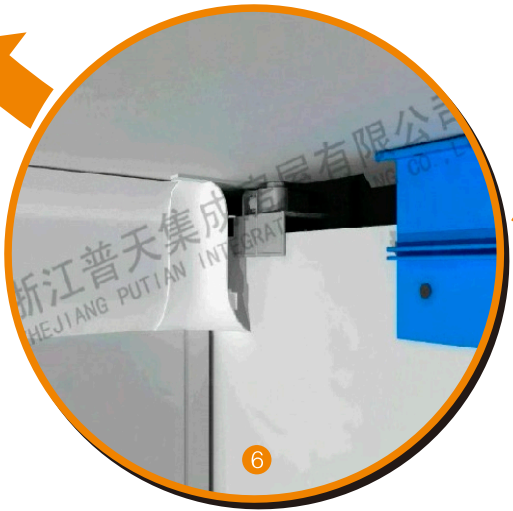

7. Install the baseboard.

