



for

LED



SimpoleD

SimpoleD-TRI-5850 for Tridonic Modular Passive LED Cooler Φ 58mm

Features VS Benefits

- * The SimpoleD-TRI-5850 Tridonic Modular Passive LED Coolers are specifically designed for luminaires using the Tridonic LED engines.
- * Mechanical compatibility with direct mounting of the LED engines to the LED cooler and thermal performance matching the lumen packages.
- * For spotlight and downlight designs from 500 to 1800 lumen.
- * Thermal resistance range Rth 3.7°C/W.
- * Modular design with mounting holes foreseen for direct mounting of Tridonic TALEX module SLE Modules engines.
- * Diameter 58mm - standard height 50mm Other heights on request.
- * Extruded from highly conductive aluminum.



Zhaga LED engine and radiator assembly is a unified future international standardization

- * Below you find an overview of Tridonic COB's which standard fit on the Cool-LED SimpoleD coolers.
- * In this way mechanical after work and related costs can be avoided, and lighting designers can standardize their designs on a limited number of LED coolers.

TRIDONIC
enlightening your ideas

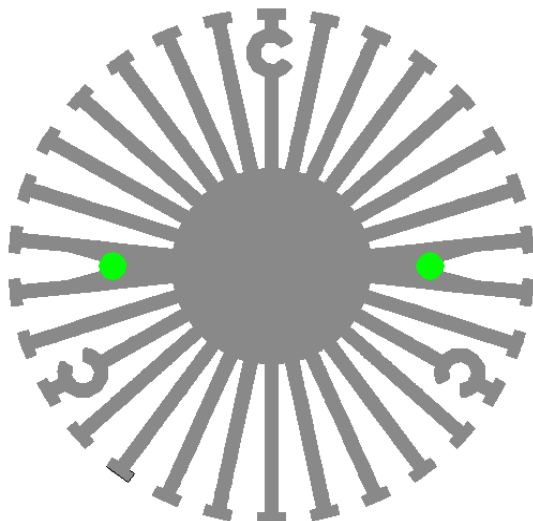

Zhaga Book3 Spot Light LED engines
LED COB's for which Zhaga book3 LED Modules holders are available

STARK SLE GEN3 Classic LED Modules:

STARK-SLE-19-2000 – Operating mode HE at 350 mA

STARK-SLE-G3-19-2000-830-CLA;

STARK-SLE-G3-19-2000-840-CLA;

STARK-SLE-19-3000 – Operating mode HE at 350 mA

STARK-SLE-G3-19-3000-830-CLA;

STARK-SLE-G3-19-3000-840-CLA;

STARK SLE GEN3 Classic EM LED Modules:

STARK-SLE-19-2000 – Operating mode HE at 350 mA

STARK-SLE-G3-19-2000-830-CLA-EM;

STARK-SLE-G3-19-2000-840-CLA-EM;

Direct mounting with machine screws M3x6mm;
Green indicator marks.



for

LED



SimpLED

SimpLED-TRI-5850 for Tridonic Modular Passive LED Cooler Φ 58mm

TRIDONIC
enlightening your ideas

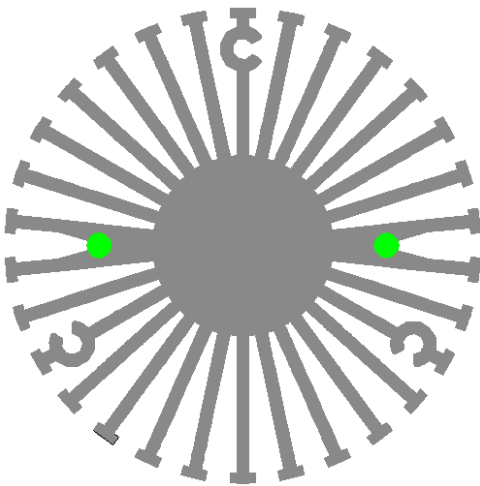

STARK SLE GEN3 Mini Classic LED Modules:
(BJB Holder:47.319.2021.50)

STARK-SLE-17-2000 – Operating mode HE at 350 mA

STARK-SLE-PURE-G3-17-2000-830-CLA;

STARK-SLE-PURE-G3-17-2000-840-CLA;

STARK SLE GEN3 Select LED Modules:

STARK-SLE-19-2000 – Operating mode HE at 350 mA

STARK-SLE-G3-19-2000-930-SEL;

STARK-SLE-G3-19-2000-940-SEL;

STARK-SLE-19-3000 – Operating mode HE at 350 mA

STARK-SLE-G3-23-3000-930-SEL;

STARK-SLE-G3-23-3000-940-SEL;

STARK SLE GEN3 Mini Select LED Modules:
(BJB Holder:47.319.2021.50)

STARK-SLE-17-2000 – Operating mode HE at 350 mA

STARK-SLE-PURE-G3-17-2000-930-SEL;

STARK-SLE-PURE-G3-17-2000-940-SEL;

STARK SLE GEN3 Art LED Modules:

STARK-SLE-19 – Operating mode HE at 350 mA

STARK-SLE-G3-PURE-19-930-ART;

STARK SLE GEN3 Fashion LED Modules:

STARK-SLE-19 – Operating mode HE at 350 mA

STARK-SLE-PURE-G3-19-FASHION;

STARK SLE GEN3 Food LED Modules:

STARK-SLE-19 – Operating mode HE at 350 mA

STARK-SLE-G3-19-GOLD;

STARK-SLE-G3-19-GOLD+;

STARK-SLE-G3-19-FM;

STARK-SLE-G3-19-MEAT+;

Direct mounting with machine screws M3x6mm;
Green indicator marks.

Tridonic LED Modules directly Mounting Options

SLE G4 Advanced LED Modules:

SLE 15mm 2000lm – Operating mode HE at 350 mA

SLE G4 15mm 2000lm 830 C ADV;

SLE G4 15mm 2000lm 840 C ADV;

Direct mounting with machine screws M3x6mm;
Blue indicator marks.



for

LED



SimpoleD

SimpoleD-TRI-5850 for Tridonic Modular Passive LED Cooler Φ 58mm

TRIDONIC
enlightening your ideas

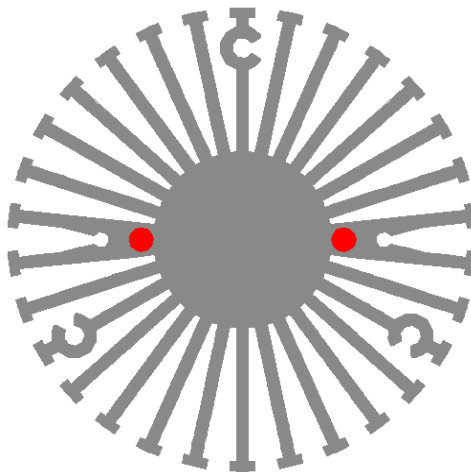
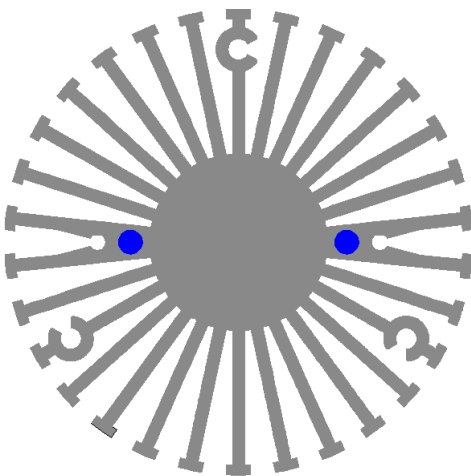
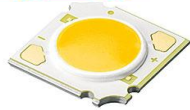

SLE G4 Excite LED Modules:

SLE 15mm 2000lm – Operating mode HE at 350 mA

SLE G4 15mm 2000lm 930 C EXC;

SLE G4 15mm 2000lm 940 C EXC;

Direct mounting with machine screws M3x6mm;
Blue indicator marks.

SLE G4 10mm R SNC LED Modules: (BJB Holder:47.319.6060.50)

SLE G4 10mm 800lm 827 R SNC;

SLE G4 10mm 800lm 830 R SNC;

SLE G4 10mm 800lm 927 R SNC;

SLE G4 10mm 800lm 930 R SNC;

SLE G4 10mm 1200lm 827 R SNC;

SLE G4 10mm 1200lm 830 R SNC;

SLE G4 10mm 1200lm 840 R SNC;

SLE G4 10mm 1200lm 927 R SNC;

SLE G4 10mm 1200lm 930 R SNC;

SLE G4 10mm 1200lm 940 R SNC;

**STARK SLE GEN3 Mini Classic LED Modules:
(BJB Holder:47.319.6060.50)**

STARK-SLE-10-1000 – Operating mode HO at 700 mA

STARK-SLE-PURE-G3-10-1000-827-CLA;

STARK-SLE-PURE-G3-10-1000-830-CLA;

STARK-SLE-PURE-G3-10-1000-840-CLA;

**STARK SLE GEN3 Mini Select LED Modules:
(BJB Holder:47.319.6060.50)**

STARK-SLE-10-1000 – Operating mode HO at 700 mA

STARK-SLE-PURE-G3-10-1000-930-SEL;

STARK-SLE-PURE-G3-10-1000-940-SEL;

**STARK SLE GEN3 Art LED Modules:
(BJB Holder:47.319.6060.50)**

STARK-SLE-10 – Operating mode HO at 700 mA

STARK-SLE-G3-PURE-10-930-ART;

Direct mounting with machine screws M3x6mm;
Red indicator marks.



for

LED



SimpoleD

SimpoleD-TRI-5850 for Tridonic Modular Passive LED Cooler Φ 58mm

Mounting Options and Drawings & Dimensions

Example: SimpoleD-TRI-5850-B-3

Example: SimpoleD-TRI-58 **1** - **2** - **3**

1 Height (mm)

2 Anodising Color

B-Black

C-Clear

Z-Custom

3 Mounting Options - see graphics for details Combinations available

Ex.order code - 12

means option 1 and 2 combined

Notes:

- Mentioned models are an extraction of full product range.
- For specific mechanical adaptations please contact MingfaTech.
- MingfaTech reserves the right to change products or specifications without prior notice.



Note !: option 1 and option 2 can't not be combined

MOUNTING OPTION	Module type	Holder NO.	THREAD	THREAD DEPTH	THREAD HOLE DISTANCE
1	SLE G4 10mm R SNC; STARK SLE GEN3 Mini Classic; STARK SLE GEN3 Mini Select; STARK SLE GEN3 Art;	BJB:47.319.6060.50 Zhaga Book11	M3	6mm	25.0mm/ 2-@180° (Zhaga Book11)
2	SLE G4 Advanced; SLE G4 Excite;	/	M3	6mm	26.8mm/ 2-@180°
3	STARK SLE GEN3 Mini Classic; STARK SLE GEN3 Mini Select;	BJB:47.319.2021.50 Zhaga Book3	M3	6mm	35.0mm/ 2-@180° (Zhaga Book3)
	STARK SLE GEN3 Classic; STARK SLE GEN3 Classic EM; STARK SLE GEN3 Select; STARK SLE GEN3 Art; STARK SLE GEN3 Fashion; STARK SLE GEN3 Food;	/			

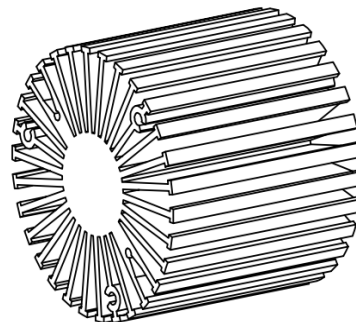
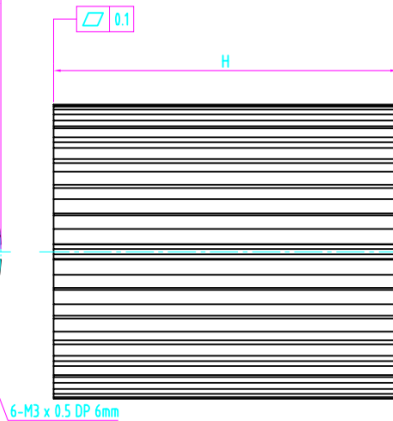
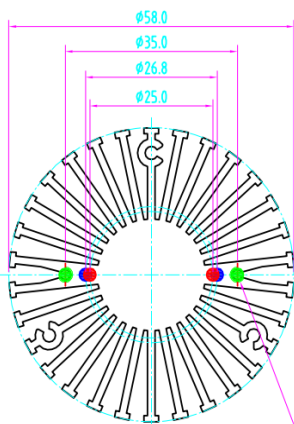

6-M3 x 0.5 DP 6mm

Tel: +86-769-39023131
E-fax: +86-(020)28819702 ext:22122
Email:sales@mingfatech.com
Http://www.heatsinkled.com
Http://www.mingfatech.com





for

LED



SimpLED

SimpLED-TRI-5850 for Tridonic Modular Passive LED Cooler Φ58mm

The thermal data table

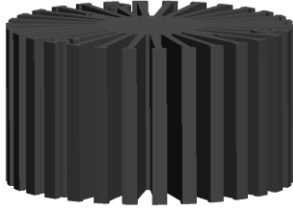
	 <i>SimpLED-5850</i>
Model No.	SimpLED-TRI-5850
Size	Φ58xH50mm
Material	AL6063-T5
Finish	Black Anodized
Weight(g)	174.0
Thermal Wattage	12.2W
HeatsinkOs-a²	65036
Heat Sink T_{Rise Above Ambient}	3.7

Dissipated Power Pd(W)	Pd = Pe x (1-ηL)	Heat sink to ambient thermal resistance Rhs-amb (°C/W)	Heat sink to ambient temperature rise Ths-amb (°C)
		SimpLED-TRI-5850	SimpLED-TRI-5850
3.0		4.83	14.5
6.0		4.16	25.0
9.0		3.82	34.4
12.0		3.58	43.0
15.0		3.40	51.0

